

John Crooks

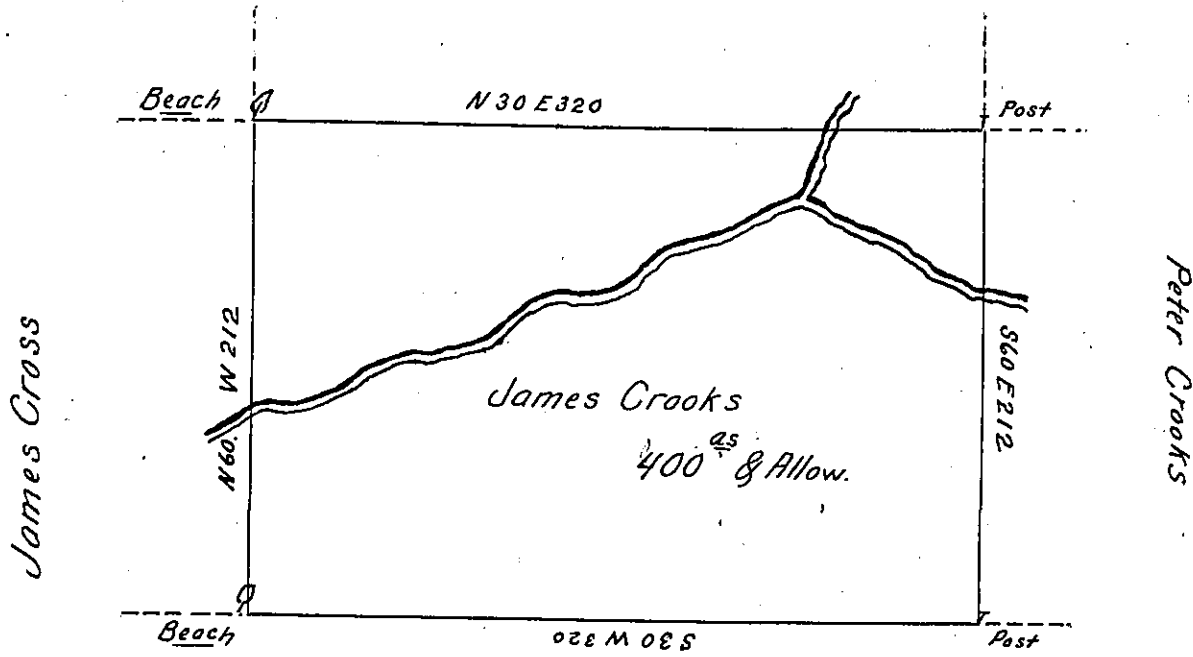

Map in Loyalsock Township, Lycoming County

Sam! Wallis & Comy.

A Draught of A Tract of Land Situate on Loyalsock Creek Adjoining Land of Peter Crooks & Others in the County of Northumberland. Survey'd on the 4th (abt.) or James Crooks in Pursuance of his Warrant (abt.) ing date the Third day of February 1789. Containing Four Hundred Acres & the Allowance of Six p. Cent for Roads &c.

To John Lukens, Esq^r }
 Surveyor Gen! }

John Wallis, D. S.

IN TESTIMONY that the above is a copy of the original remaining on file in the Department of Internal Affairs of Pennsylvania, made conformably to an Act of Assembly approved the 16th day of February, 1833, I have hereunto set my Hand and caused the Seal of said Department to be affixed at Harrisburg, this twenty sixth day of April 1904.

Loac D Brown
 Secretary of Internal Affairs.